

Installation and User Guide

Plasma Range 5.5L Sani Bin

Applicable to products:

92342SS	Plasma 5.5L Sani Bin - Brushed
92342WH	Plasma 5.5L Sani Bin - White Powder Coated
92342BK	Plasma 5.5L Sani Bin - Black Powder Coated



Thank you for choosing the Dudley Industries Free Vend Dispenser.

The 5.5 Litre Sani Bin is designed and manufactured by our team at our facilities based in Lancashire, UK. All our products are designed to withstand constant use in busy environments. Our Sani Bin is supported by a 10 year warranty provided it is installed and maintained correctly and not subject to any vandalism. Products must not be modified in any way as this will invalidate the warranty.

Please follow these instructions for safe installation and pass this document to the user for safe keeping.



Safety Information

Please read these instructions thoroughly before installation and retain for future reference.

Remove all packaging and check contents for any damage prior to commencing installation. If there are any issues please contact our Customer Services Team on +44 (0) 1253 738311.

Before commencing installation and drilling into walls check that there are no hidden electrical cables or water pipes.

When using power tools always ensure you wear the correct PPE and operate following the manufacturer's instructions.



Product Features

The 5.5L Sani Bin has a compact design, ideal for cubicles with limited space. It is suitable for all types of hygiene waste and has a convenient built in bag holder for waste bags, ensuring easy and hygienic disposal.

Units are manufactured in stainless steel for a durable, rust-resistant and easy to clean surface with the choice of brushed or powder coated white and black finishes.

Unit Dimensions

General Assembly:

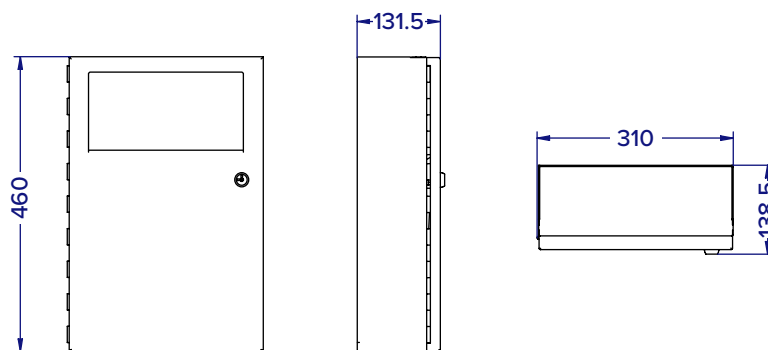

Fixing Holes:

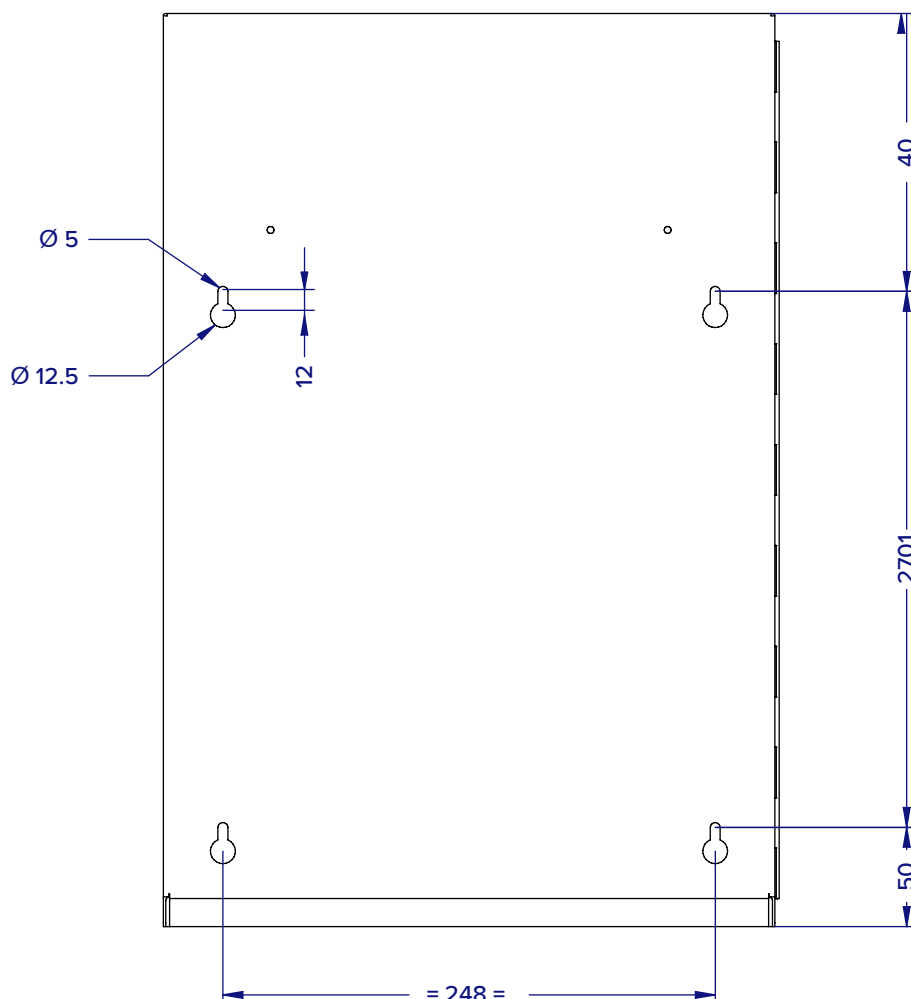

The 5.5L Sani Bin can be floor standing without the need to fix to a wall. For added security or to raise the bin up from the floor to aid floor cleaning the units can be wall mounted. To wall mount please follow the installation instructions.

PRODUCT INSTALLATION

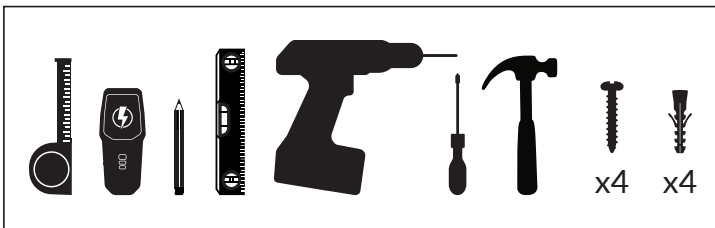

It is the customers responsibility to ensure the correct fixings are used for the intended purpose.

- Measure and mark the position of the fixing holes on the wall (using the diagram on page 3) ensuring that they are level.
- Before commencing drilling into walls check that there are no hidden electrical cables or water pipes.
- Drill holes in the wall using the appropriate size drill bit. Drill to the depth of the wall plugs being used. If the surface is tiled, drill into the grout lines whenever possible. Insert the wall plugs.
- Screw two screws into the top holes leaving 0.5-1cm (0.2-0.39") protruding from the wall.
- Open the front of the unit, with key provided and remove the waste bin. Hook the top fixing holes (A) onto the screws in the wall.
- Insert two screws into the bottom fixing holes (B) and tighten all four screws to secure the unit. We always recommend that you use all fixing holes available for strength and security.
- Re-insert the waste bin before closing and locking the front.

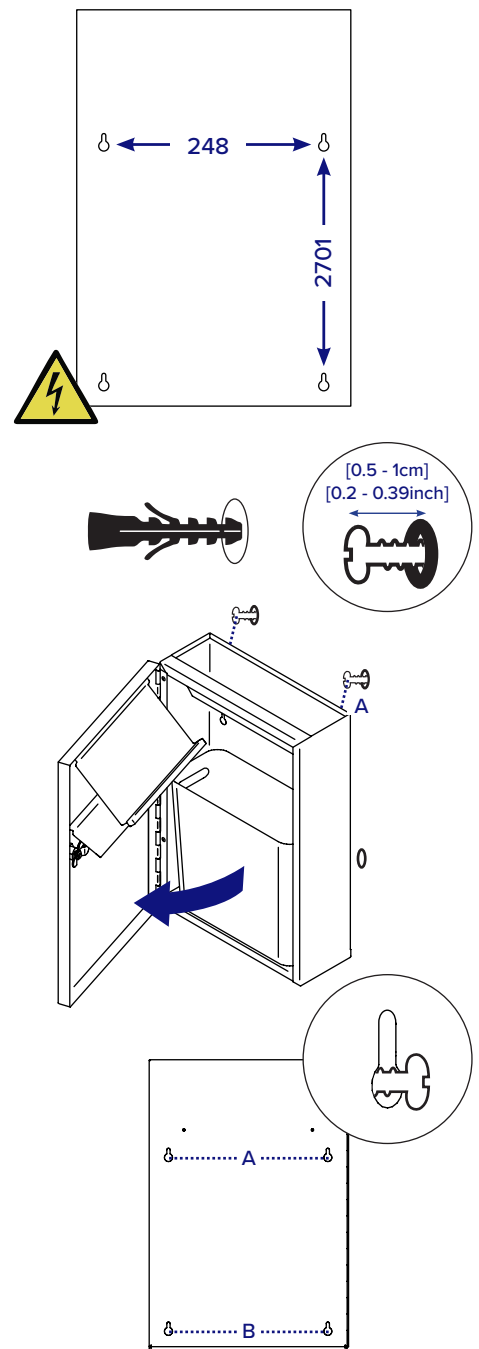

General Maintenance & Cleaning

Brushed Stainless Steel Units:

Clean with warm water and a soft cloth, wipe in the same direction as the brushed grain. Dry thoroughly. DO NOT use soap, chemical cleaning detergents or abrasive cleaners.

Powder Coated & Lacquered Units:

Clean with a mild detergent and soft cloth. Ensure any detergent is fully rinsed off prior to drying thoroughly.

End of Life Disposal

All Dudley Industries units are manufactured to ensure longevity and a reliable life span. When the free vend dispenser has reached its end of life it should be disposed of in a safe manner. Most components can be re-cycled in accordance with your local authority waste management policy.

Dudley Industries Ltd
Preston Road, Lytham St Annes, Lancashire. FY8 5AT



Tel: +44 (0) 1253 738311
Email: sales@dudleyindustries.com
Web: www.dudleyindustries.com